

PLAN VIEW:

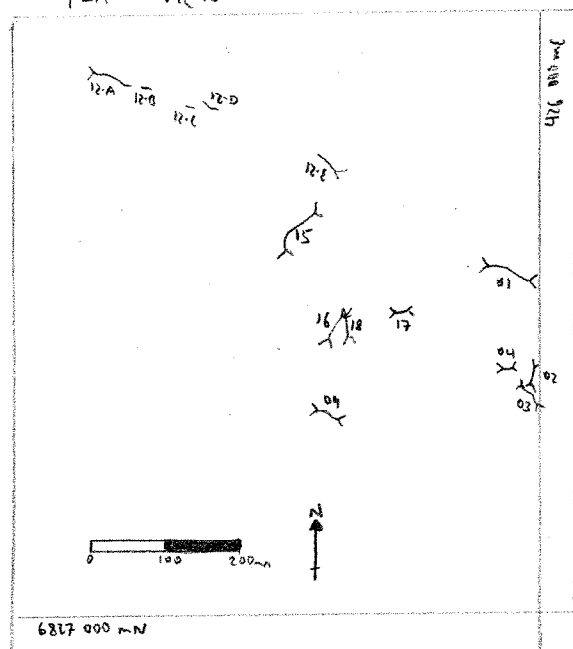

STRING PROPERTY

TR-11-04

NORTH RIB

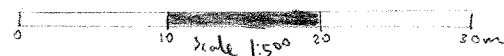

* Note: Trench fractured / fragmented rock, unless specified otherwise.

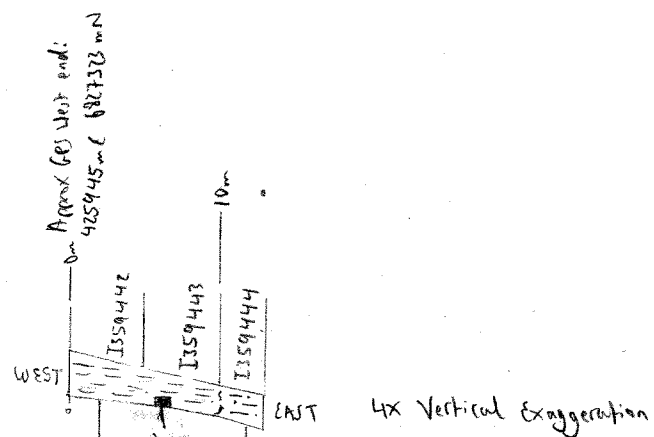

ARGILLITE

Very fine, finely laminated, dark grey/brown-perpendicular to laminations w/ pervasive red/brown speckly alt'n. Graphite-bearing - lamination surfaces are greasy to metallic grey w/ hard, dark grey & minor orange alt'n.

@ 0-1 & 2m: Abundant chips of white, massive qtz, up to cobble-sized. Limonite alt'n on wx surfaces & fractures.

@ 3 & 10m: Massive orange/tan flots, highly alt'd.

@ 7 & 9m: Scattered massive qtz flots, to pebble size.

shallow trench, composite chips in poorly sorted H.U.

MIX

Argillite mixed w/ massive, fine tan/pink & orange carbonate-alt'd volcanic w/ minor green clasts & calcite veining.

AZM: 0-13 @ 085°

LEGEND:

Interred contact

LITHOLOGIES:

Argillite

Mixed rock

Abbreviations:

qtz = quartz

wx = weathering

alt'n = alteration